



Custom-made surfaces price list and installation instructions



Custom-made surfaces

We will manufacture your custom-made Spectra Slim-Edge surfaces to whatever shape and size you need. And we can add features such as sink and hob cut-outs, drainer grooves and butt joints. Saving you time and money and those tricky bespoke shapes can easily be achieved with precision and perfection.

Worktop shape and features

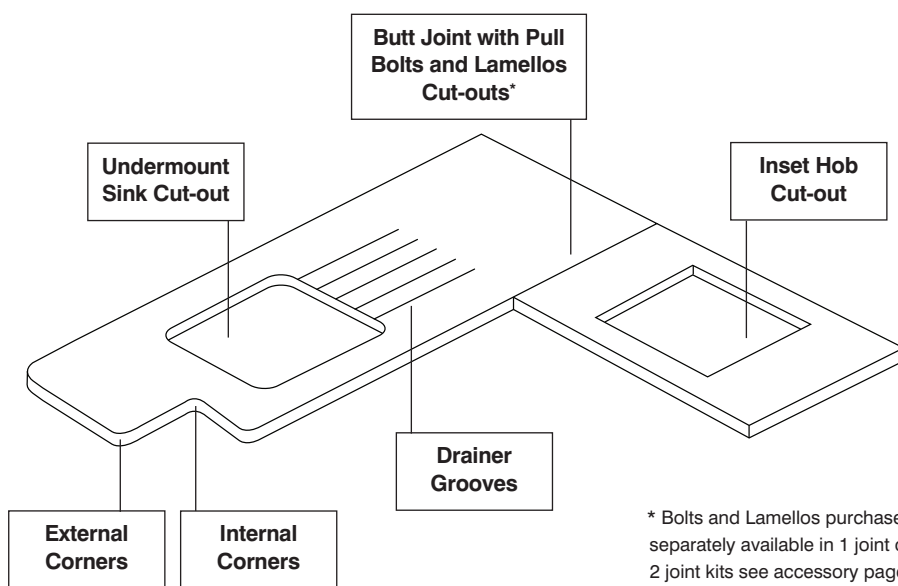

Quoting your custom-made surface

Quoting your custom-made surface couldn't be easier with our handy online quoting tool. You can specify your décor, dimensions and any additional features you may require.

Access the online quoting tool by visiting
blackheathproducts.co.uk/calculator



The Process

Step 1 - Design your worktop

First, arrange a sketch of the Spectra Slim-Edge surfaces you need, showing the selected décor, shapes and dimensions.

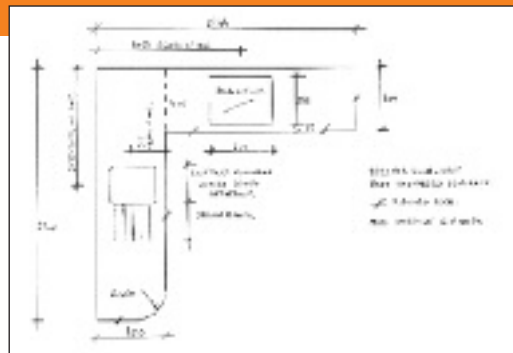

Step 2 - Approval

When we have received your drawing, we'll create a technical working drawing and send it to you to approve and confirm price.

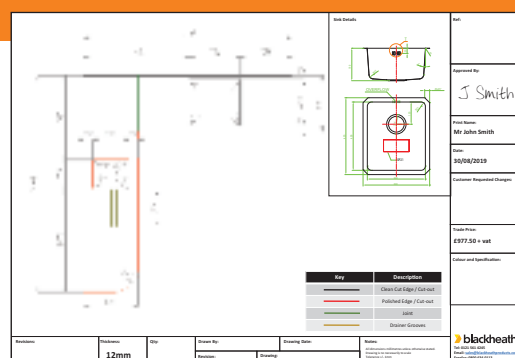

Step 3 - Manufacture

Once we've received your signed written approval of our technical drawing, we'll get down to work and produce your custom-made Spectra Slim-Edge surfaces.



Step 4 - Delivery

After we've triple-checked your completed custom-made surfaces we'll deliver them within three weeks of receiving your signed off drawing approval.



Specification guidance

Size

We strongly advise that you send us dimensions that are deliberately over size. Please refer to 'Worktop configuration' below for more details. This will allow you to scribe your surfaces to exactly fit on site.

Any offcuts will be sent to you (free of charge), unless you tell us not to.

Shape

Your custom-made surfaces can be cut to size and shaped with as many curves and corners as you need. They will be all included within the standard cut to size prices shown.

Edges

All edges are sawn clean and finished with a 1mm chamfer top and bottom.



Undermount Sink cut-outs

Please tell us the make and model and provide the cut-out dimensions along with a DXF file of your sink.

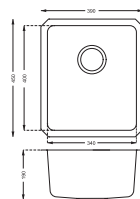

A bowl and a half sink that comprises of 2 sinks will be charged as 2 cut-outs. Whereas if the bowl and a half sink is formed within 1 sink unit then the charge will be for 1 cut-out.

Unless specified undermount sink cut-outs will be produced to the following specification:

- Sink Length less 10mm
- Sink Width less 10mm
- Sink Radius less 5mm

Inset Sink cut-outs

Please tell us the make and model and provide the cut-out dimensions.

Drainer grooves

Our prices are based on 5 straight grooves per drainer area. Unless specified drainer grooves will be produced to the following specification:

- Number of grooves 5
- Length of grooves 390mm
- Depth of grooves 1.2mm to 4mm
- Width of grooves 8mm to 12mm

Hob cut-outs

Please tell us the make and model and provide the cut-out dimensions.

Please note that all hob cut-outs will have a 9mm internal corner radius.

Dimensional tolerance

All measurements are within +/- 1mm.

Delivery

3 weeks after approval of the dimensions and specification.

Worktop configuration

It is important that you let us know how your custom-made surfaces will be positioned within the room design by sending us a sketch.

Our advice is that most surfaces are supplied over size so that you avoid the need for expensive templating. Please see the configuration example shown here for details.

Configuration example:

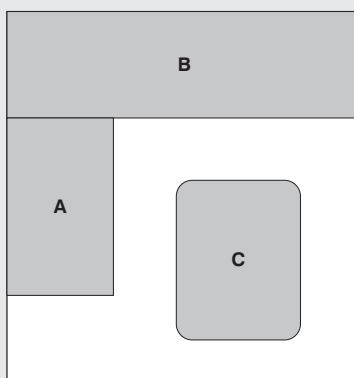

A - Open End Worktop

Worktop A is open at one end so it should not be necessary to supply this over size.

B - Restricted Worktop

Worktop B is fixed in size between 2 walls. We will supply this over size for you to scribe accurately on site.

C - Island Worktop

Worktop C is an island and can be supplied to the exact size required with finished edges.

Diagram example

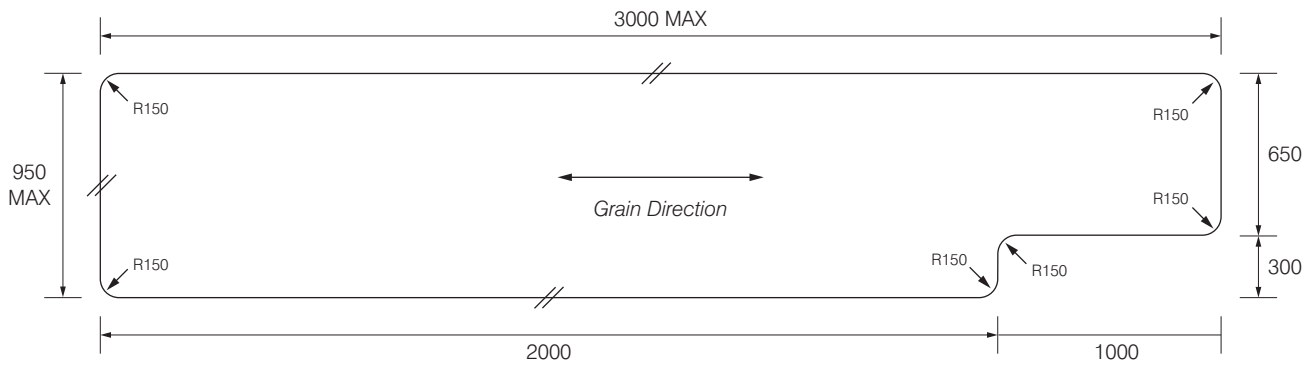

Radius restrictions: Minimum internal radius 30mm, Minimum external radius 30mm

Measurements required for sink position

Inset Sinks / Hobs

- A Overall length
- B Width
- C Distance to centre cut-out
- D Width of cut-out
- E Distance front edge to start of cut-out
- F Depth of cut-out
- R Radius is 9mm unless stated

Also Include:
Sink/Hob make and model

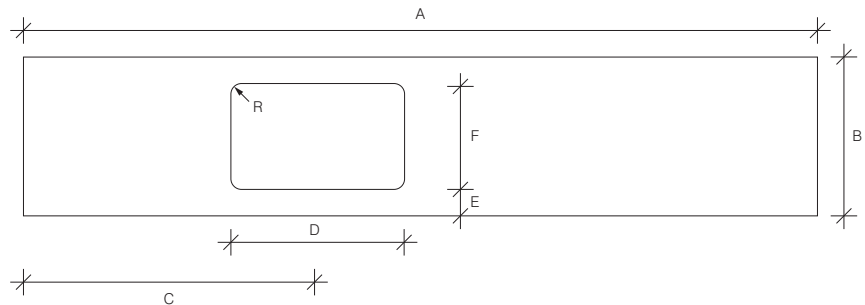

Undermounted Sinks

- A Overall length
- B Width
- C Distance to centre of sink in length
- D Distance to centre of sink in width
- E Drainer grooves L/H or R/H
indicate on drawing max length
required if restricted

Also Include:
Sink make and model

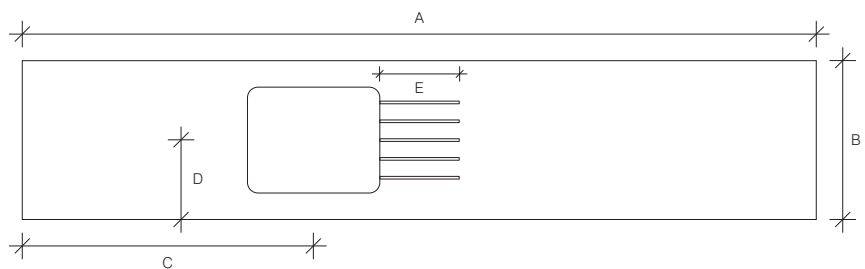

Belfast/Butler Sinks

- A Overall length
- B Width
- C Distance to centre of sink
- D Width of cut-out
- E Depth of cut-out
- F Drainer grooves L/H or R/H
indicate on drawing max length
required if restricted

R Radius is 9mm unless stated

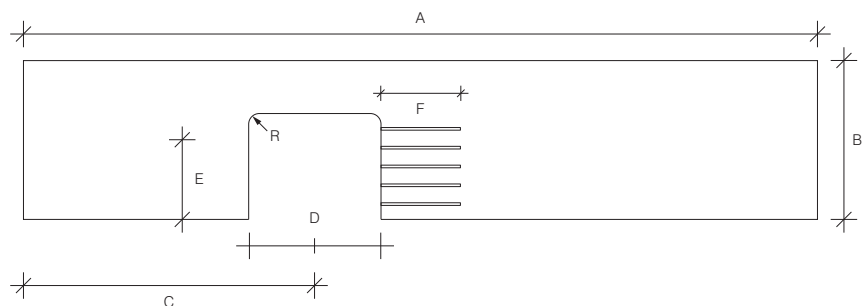

Draw your custom-made surfaces design including any additional features such as sink and hob cut-outs.

Order Details

Décor
Contact Name
Company
Telephone
Project Name
Date

Ex Stock Components

	Qty		Qty
3050 x 650 x 12mm Worktop	<input type="text"/>	Installation kit 1	<input type="text"/>
3050 x 950 x 12mm Breakfast Bar	<input type="text"/>	Installation kit 2	<input type="text"/>
3050 x 95 x 12mm Uprand	<input type="text"/>	45m Heat Reflective tape	<input type="text"/>
3050 x 650 x 12mm Splashback	<input type="text"/>	3m Heat Reflective tape	<input type="text"/>
3050 x 950 x 12mm Splashback	<input type="text"/>	Spectra Seal 290ml	<input type="text"/>

Décor

To optimise functionality, every Spectra Slim-Edge worktop, breakfast bar and island surface features the same stylish décor on both sides. The coloured edges of each décor are also shown.

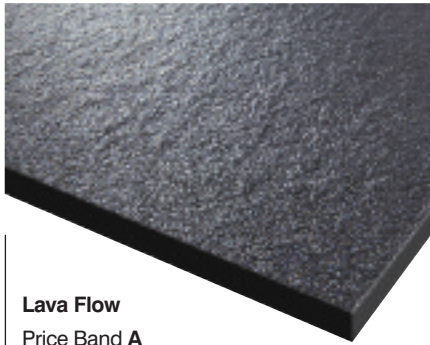

Lava Flow
Price Band **A**
Texture **Slate** / Core **Black**

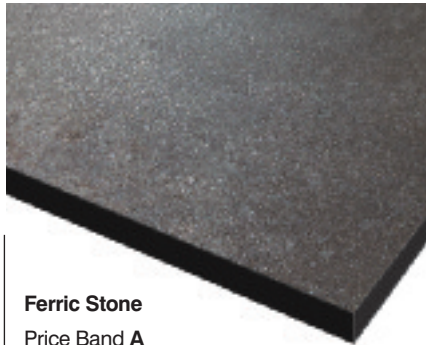

Ferric Stone
Price Band **A**
Texture **Nature** / Core **Black**

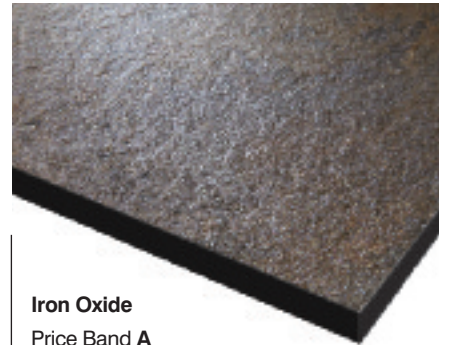

Iron Oxide
Price Band **A**
Texture **Slate** / Core **Black**

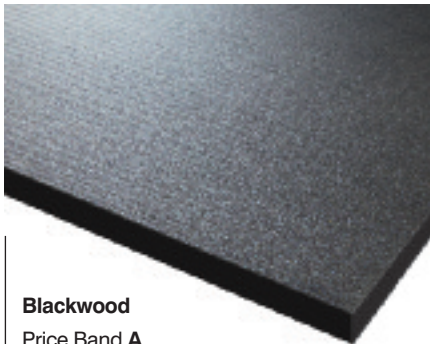

Blackwood
Price Band **A**
Texture **Wood** / Core **Black**



Woodstock
Price Band **A**
Texture **Wood** / Core **Black**

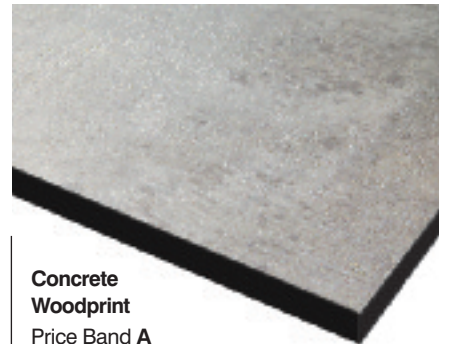

Concrete Woodprint
Price Band **A**
Texture **Nature** / Core **Black**

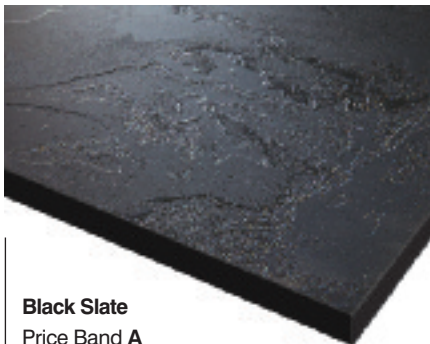

Black Slate
Price Band **A**
Texture **Slate** / Core **Black**

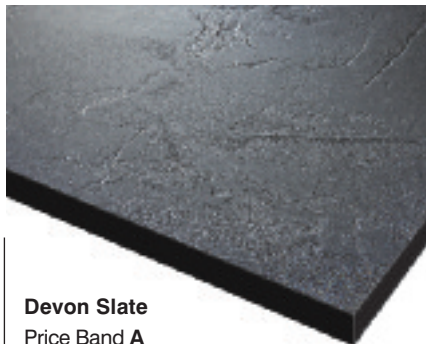

Devon Slate
Price Band **A**
Texture **Slate** / Core **Black**

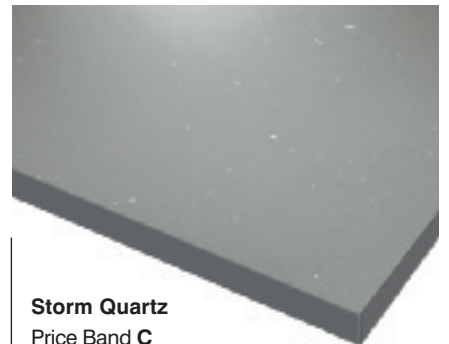

Storm Quartz
Price Band **C**
Texture **Matt** / Core **Dark Grey**

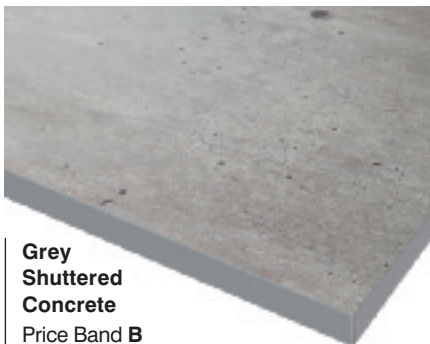

Grey Shuttered Concrete
Price Band **B**
Texture **Matt** / Core **Light Grey**



White Italian Marble
Price Band **B**
Texture **Matt** / Core **White**



Calm White Quartz
Price Band **C**
Texture **Matt** / Core **White**

Price list

Surfaces - cut to size including all the curves you need

12mm worktop or splashback cut and shaped up to 3000 x 650mm

Price Group A décors	
Cut without Curves	£217.25
Cut with Curves	£279.75
Price Group B décors	
Cut without Curves	£306.25
Cut with Curves	£368.75
Price Group C décors	
Cut without Curves	£324.25
Cut with Curves	£386.75

Prices are for each worktop or splashback

12mm breakfast bars and island units cut and shaped up to 3000mm x 950mm

Price Group A décors	
Cut without Curves	£402.25
Cut with Curves	£439.75
Price Group B décors	
Cut without Curves	£547.25
Cut with Curves	£584.75
Price Group C décors	
Cut without Curves	£582.25
Cut with Curves	£619.75

Prices are for each breakfast bar and island unit or splashback

Décor	Texture	Core
Price Band A		
Black Slate	Slate	Black
Blackwood	Wood	Black
Concrete Woodprint	Nature	Black
Devon Slate	Slate	Black
Ferric Stone	Nature	Black
Iron Oxide	Slate	Black
Lava Flow	Slate	Black
Woodstock	Wood	Black
Price Band B		
Grey Shuttered Concrete	Matt	Light Grey
White Italian Marble	Matt	White
Price Band C		
Calm White Quartz	Matt	White
Storm Quartz	Matt	Dark Grey

Additional features - add these prices to the cut to size prices

Unpolished Inset sink or Hob Cut-out



Polished Undermount Sink Cut-out
with polished edge cut-out



Drainer Grooves
Set of 5 grooves



Butt Joint with Cut-outs for supplied Pull Bolts and Lamellos Cut-outs*



* Bolts and Lamellos purchased separately available in 1 joint or 2 joint kits see accessory page.

Pricing Example:

Group A décor worktop 2400 x 650 x 12mm - with 3 curves	£279.75
+ Unpolished inset sink or hob cut-out	£61.25
+ 1 set of 5 drainer grooves	£98.75
Total	£439.75

All prices subject to VAT

Accessories

Installation kit 1

Suitable for 2 worktop joints up to 950mm and undermount sink installation

+ £29.77



Contents:

2 x 20g Tube TopSeal (to match worktop)
2 x TopSeal Applicator Tool
1 x 20ml Bottle of Acetone
6 x Clear Lamellos
1 x 20ml Bottle of Linseed Oil
10 x Brass Spreader Dowels
10 x M6 10mm Roofing Bolts
6 x Toggle Bolts (Worktop Connector Bolts)
1 x 3mm Hex Key
3 x 180 Grit Sandpaper Sheets
3 x 240 Grit Sandpaper Sheets
2 x Nylon Finishing Pads (320 Grit approx.)
1 x Drill Bit with depth stop

Installation kit 2

Suitable for 1 worktop joint up to 950mm

+ £12.68

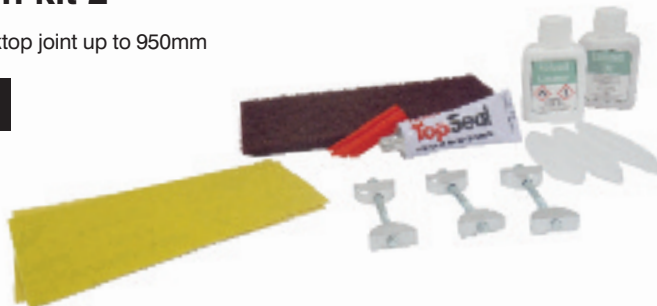

Contents:

1 x 20g Tube TopSeal (to match worktop)
1 x TopSeal Applicator Tool
1 x 20ml Bottle of Acetone
3 x Clear Lamellos
1 x 20ml Bottle of Linseed Oil
3 x Toggle Bolts (Worktop Connector Bolts)
1 x 3mm Hex Key
1 x 180 Grit Sandpaper Sheet
1 x 240 Grit Sandpaper Sheet
1 x Nylon Finishing Pad (320 Grit approx.)

Heat ReflectiveTape

45m x 50mm Roll

+ £9.41

3m x 50mm Roll

+ £3.13



Spectra Seal

290ml

+ £7.48



White
(SPECTSEAL010)



Clear
(SPECTSEAL011)



Light Grey
(SPECTSEAL016)



Dark Grey
(SPECTSEAL017)



Black
(SPECTSEAL018)

Uncut price list

	Price Band A	Price Band B	Price Band C
3050 x 650 x 12mm Worktop	£174.85	£257.11	£276.71
3050 x 950 x 12mm Breakfast Bar	£325.06	£487.99	£527.18
3050 x 95 x 12mm Upright	£39.05	£48.86	£51.65
3050 x 650 x 12mm Splashback	£174.85	£257.11	£276.71
3050 x 950 x 12mm Splashback	£325.06	£487.99	£527.18

Installation instructions

IMPORTANT: Please inspect this product fully prior to fabrication or installation (including colour, texture, profile, visible imperfections and defects), as any consequential fitting costs due to these visible discrepancies will not be accepted at a later stage.

INSTALLATION TOOLS

The following list of tools is recommended to produce the best results.

■ **Hand Held Circular Saw** Use a circular saw with high quality TCT triple chip blades for a fine finish cut. A hand router must be used for the final sizing of exposed edges. Allow at least 2-3mm oversize for the final pass. A variable rotation speed and high quality double flute tungsten carbide tipped cutter is used for straight cuts, mitre joints and cut-outs.

■ **Extraction Unit** With adequate capacity.

■ **Hand Router**

■ **Random Orbital Sander** 180 grit - 240 grit sanding discs.

■ **Scotchbrite™ Pad** To sand the exposed front edge after cutting or trimming. Ensure a good quality orbital palm sander and extraction unit is used.

■ **Palm Sander**

■ **Electric or Battery Drill** Use a good quality variable speed drill with 1/2" chuck. Standard high speed drill bits are suitable for Spectra Slim-Edge work surfaces.

■ **Edge/Profile Trimmer** To apply a profile on any exposed cut edges. Use a fixed tip guide trim cutter with a profile trim cutter.

■ **Speed Clamps**

■ **Suction Clamps** Used to clamp two pieces together and secure in position.

■ **Silicone Sealant** Waterproof and mould resistant sealant for sealing sinks and bonding work surfaces to the base units.

■ **Aluminium Tape** Used to reduce the heat transfer between the hob and internal cut-out.

■ **Jigsaw and Metal Cutting Blades**

■ **Installation Kit 1** Suitable for 2 worktop joints up to 950mm and 1 undermount sink installation. The kit includes: 2 x colour matched 20g topseal and applicators, 6 x toggle bolts, 1 x 20ml Acetone cleaner, 6 x clear lamellos, 1 x 20ml bottle of linseed Oil, 10 x brass spreader dowels, 10 x M6 10mm roofing bolts, 6 x toggle bolts, 1 x 3mm hex key, 3 x 180 grit sandpaper sheets, 3 x 240 grit sandpaper sheets, 2 x nylon finishing pad 320 grit approx, 1 x drill bit with depth stop.

■ **Installation Kit 2** Suitable for 1 worktop joint up to 950mm. The kit includes: 1 x colour matched 20g topseal and applicator, 3 x toggle bolts, 1 x 20ml acetone cleaner, 1 x nylon finishing pad 320 grit approx, 3 x clear lamellos, 2 x 180 and 240 grit sandpaper sheets, 1 x 20ml linseed oil.



**CAUTION: HEAVY PRODUCT
RECOMMENDED 2 MAN LIFT**



**PLEASE CARRY VERTICALLY ALONG
THE LENGTH TO AVOID ANY DAMAGE**



HANDLING AND PLANNING

Handling

Before handling please ensure adequate manpower is available to safely lift the work surface. Work surfaces should always be carried by two people. When carrying manually, we advise that it is held vertically along the width. Do not carry flat.

Planning

The positioning of the joints is very important so careful planning is required to achieve the best results. Joints must be a minimum of 150mm from a hob / sink cut out and must be fully supported.

Fixing

When securing Spectra Slim-Edge work surfaces to the cabinets cut blocks of MDF approximately 50 x 18 x 18mm. Apply silicone to the top and side of the blocks and adhere to the side wall of the cabinet and the underside of the work surface. Should the surface ever need to be removed in the future simply remove the blocks.

Appliance Considerations

Any heat generating appliances, such as an AGA, that are adjacent to the work surface should be positioned a minimum of 50mm from the end. There is no restriction on the positioning of integrated dishwashers, washing machines or tumble dryers, however it is recommended that an 18mm mfc panel be fitted directly above the appliance by securing it to the adjacent cabinet sides. For free standing appliances we recommend the unsupported length to be a maximum of 600mm which will restrict the use of appliances positioned side by side.

Storage

Spectra Slim-Edge work surfaces must always be stored in a ventilated, dry, enclosed area, face up, flat and supported the full length. When stacking, check for and remove any particles that may get in between the work surfaces and cause abrasion damage. During installation Spectra Slim-Edge work surfaces can be stored vertically on the long edge, for short periods.

Thermal expansion

Thermal expansion for Spectra Slim-Edge is 1mm for every metre.

Summary

Do

- ✓ Always check for design and colour compatibility before fitting.
- ✓ Ensure a 50mm ventilation gap between the end of the work surface and any heat generating appliance.

Don't

- ✗ Never drill Spectra Slim-Edge solid laminate work surfaces without the use of a solid base underneath to avoid breakout or flaking on the exit side of the work surface.
- ✗ Never use auger type drill bits.

CUTTING

Spectra Slim-Edge work surfaces are hardwearing and require good quality machinery and clean, sharp cutters to produce a professional finish that ultimately saves time and effort. Cutting Spectra Slim-Edge work surfaces can be carried out using a portable hand-held circular saw.

1. All joint edges and final finished ends must be skimmed using a hand router with a sharp blade. Allow for 2-3mm for final skim to size.
2. Check measurements repeatedly to avoid costly errors.
3. Slow or soft start tools must achieve full speed before beginning cuts.
4. Ensure all work surfaces are adequately supported during all cutting processes.
5. Use appropriate clamps to ensure there is no movement of the guide during the cutting process.
6. Having a sharp top edge and smooth jointing face is the key to a satisfactory joint.
7. Check the quality of the fit.
8. Repeat the trimming process if necessary.
9. Ensure the cut is cleaned to allow for a good bond and finish to the joint.

SCRIBING

When scribing the work surface to the wall with a circular saw or jigsaw (jigsaw blade fitted with a metal cutting blade), also sand top and bottom edges to remove any chipping that may have occurred during cutting.

1. Use a pencil to mark the required cut line on the work surface. We recommend using a scribing tool.
2. If this line is straight it will be possible to use a circular saw and perform the cut in the same manner as you would cut to length, except the cut line will be angled. (Fig 1)
3. Remember you may have a margin for error dependent on the upstands / tiling used above the work surface.
4. However if a straight cannot be achieved the cut will have to be performed using a jigsaw with a metal cutting blade.
5. Don't forget to sand top and bottom edges with 240 grit sandpaper to remove any chipping. (Fig 2)

Top Tip: It is advisable to carry out a dry fit prior to installation once all the components have been prepared.

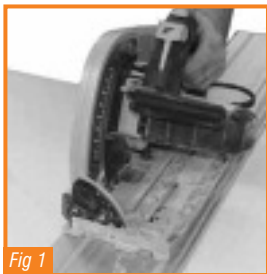

Fig 1



Fig 2

JOINTING

Dependant on the Kitchen layout we recommend the use of either installation kit 2 for one joint up to 950mm or installation kit 1 for two joints up to 950mm.

Joint Layouts - Straight, Corner and Peninsula

The joint on a straight run can be manufactured to be a discreet joint or just left to show the factory finished ends, though this will be a more visible joint.

Using a router fitted with either a high quality double flute tungsten carbide tipped cutter or an upward cutting spiral and a straight edge, add 3mm to the length leaving 3mm to trim back for final finish to achieve a good clean square edge.

Jointing Assembly

1. The work surface edges to be bonded together must be milled and straight, ensuring both surfaces are exactly parallel to secure a good discreet joint.
2. Using a biscuit joint, machine slots to suit No.20 Lamello biscuits. (Fig 3) Using the appropriate worktop jig slots for bolts should be cut at this point 3 per joint.
3. If the work surface is a dark colour use masking tape to mark out where your slots are positioned. Cut slots 4mm down from the top face.
4. Make sure your No.20 biscuits fit. (Fig 4)
5. Pull together the two pieces to be joined as a dry fit only. If gaps or chipping have occurred re skim. Clean the surfaces to be joined using acetone supplied in the joining kit or industrial denatured alcohol. Allow to evaporate dry.
6. Apply adhesive to the biscuit grooves and final bead of adhesive along the edge of the top surface and front and back edge. This will help squeeze out the surplus adhesive and achieve an inconspicuous and secure joint.

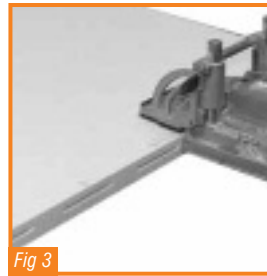

Fig 3

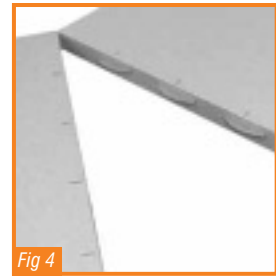

Fig 4

7. Bring the two work surfaces together and align the front edges. Then level top surface using either of the three methods below:
 - a) Suction Cup Method
This is the easiest method to pull both edges together and level the joint. (Fig 5)
 - b) Hot Melt Blocks
Wooden blocks can be hot-melted on to the surface and left to cure. Using G-clamps pull the two edges together making sure the ends are level. (Fig 6) Blocks should be lightly tapped to remove and any residue removed with the denatured alcohol.
 - c) Bolts
Bolts are supplied in joint kits 1 & 2 these are simply tightened allowing excess adhesive to squeeze out. Take care not to overtighten.

Please note: When joining smaller pieces ensure that the work surfaces remain in a horizontal plane as they have a tendency to 'jack knife'. Speed clamps placed at each end and gently tightened will stop this occurring.



Fig 5

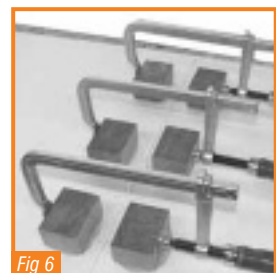

Fig 6

- Adhesive excess must be removed at this stage from the joint before it hardens. Take care when doing so to ensure the joint remains fully closed. Adhesive overspill elsewhere on the surface may be wiped off using denatured alcohol. Go across the joint with a ruler or similar to feel if a step exists. If a step is found, then tap down until both sides are flat and level and re-tighten clamps. Ensure that you clean with denatured alcohol.

Masons Mitre Joint

A typical masons mitre with biscuits is recommended for corner joints by using a work surface jig to create a discreet joint.

- Using locating pins place and clamp the jig. Then, using a router with a 30mm bush guide fitted with a good quality double fluted tungsten carbide tipped cutter or an upward cutting spiral, plunge down in incremental stages of 3-4mm until a full cut has been achieved. Using the appropriate worktop jig slots for bolts should be cut at this point 3 per joint.

Left Hand 90 Degree Joint

- Female joint router work surface face up
- Male joint router work surface face down

Right Hand 90 Degree Joint

- Female joint router work surface face down
- Male joint router work surface face up

- Once all cuts have been completed, biscuits slots must be formed by following all the relevant instructions on jointing assembly.

DRILLING

- Holes and inserts can be drilled through part of the thickness or through whole. In the case of stopped holes a minimum thickness of 2-3mm of the material must remain (i.e maximum depth hole of 10mm), otherwise there is a risk of the surface cracking when fitting.
- If going through the full work surface then place a sacrificial piece of chipboard or MDF on the underside to avoid flaking.
- Pilot hole for diameters for self-tapping screws or inserts to a maximum of 10mm are: 3mm - No.6 screw; 4mm - No.8 screw; 4.5mm - No.10 screw. For inserts to hold sink clips follow recommended instructions.
- For sink clips, pilot hole to a radius of the chosen size of insert and to a depth of 8.5mm and then insert a brass spreading dowel.

Tap holes should be cut completely through the Spectra Slim-Edge work surfaces allowing the work surface to support the tap.

- Position the tap as required ensuring clearance of any fittings. We recommend the use of installation kit 1 which contains a stopped drill inserts and bolts.
- Use a pencil mark on the surface where tap is positioned. Cut the tap hole using a suitable hole-saw to the correct tap dimension.
- Ensure the tap is installed following the manufacturer's instructions to prevent moisture entering the tap hole. It is recommended to seal the tap body to the work surface with an excess of silicone sealant to prevent water from penetrating the tap hole.
- Place a sacrificial piece of chipboard or MDF on the underside to avoid flaking.

PROFILING EDGES

Use appropriate safety equipment while performing any shaping or profiling. The use of an extraction unit to remove debris is important.

To match any exposed cut edges to the manufactured edges, simply use a 240 grit sanding block to lightly soften the edge, the recommended profile is square but this will remove the sharpness of the raw edge.

Ensure all router blades are sharp and chip free and all bearings in

the router and cutters are sound, to prevent router chatter and deep cutting. If a jig is to be used it should be damage free and completely smooth.

Top Tip: Always router into the face, this will reduce the possibility of chipping and flaking.

The use of a bottom bearing cutter is recommended.

- Check measurements repeatedly to avoid costly errors.
- Always allow slow or soft start tools to achieve full speed before beginning.
- Use speed clamps to hold the jig and work surface in place if a bottom bearing cutter is not being used.
- Always use a router / trimmer fitted with a bottom bearing radius cutter or alternatively use 240 grit sand paper and a hand block to create a chamfered edge. (Fig 7)
- The smoother the face that the profiler bearing runs on the better they travel and the better the end result.

Shaping

- Place your jig on the work surface, secure it with clamps and then mark its position.
- Mark the outline of your shape by running an offset scribe around the jig.
- Use a jigsaw to remove the excess material following pencil lines.
- Always use a router to create the finished edge. (Fig 8)
- The smoother the front edge that the radius bearing runs on the better they travel and the better the end result, this can also be achieved by means of softening the edge by using sandpaper and hand block to round off to a pencil round radius.



Fig 7



Fig 8

SINK INSTALLATION

Spectra Slim-Edge work surfaces are ideally suited for inset (Fig 9) and undermount (Fig 10) sinks.



Fig 9



Fig 10

Inset Sinks

Stainless steel and composite inset sinks can be fitted by the following instructions;

- The distance between the inset sink cut-out and an adjacent seam joint must be a minimum of 150mm and a minimum of 40mm from the front edge of the work surface.

2. Choose the location of the sink. Place the sink upside down on the face of the work surface and mark around the outline with a soft pencil.
3. Using a straight edge draw a second line at least 10-12mm inside the first line of the sink perimeter or to the manufacturer's guidelines. This should allow the inset sink to fit cleanly in to the aperture once the inner section is removed. Ensure all work surfaces are adequately supported during all cutting processes.
4. Using a 10mm bit drill each of the 4 corners of the inner line to create a clean radiused corner. This will prevent any potential stress cracking in the corners.
5. Following the inner line, plunge with a hand router fitted with a 12mm cutter or a circular saw with a guide rail and TCT triple chip blade. Plunge in three stages of 4mm depth increments. Alternatively use a handheld jigsaw to complete the cut-out into the radiused corners.
6. Once the cut out is complete gently rub the inside of the cut-out with a 240 grit sandpaper to smooth the edges and eliminate any potential micro-fractures.
7. Apply a bead of silicone on the face of the work surface around the cut-out and insert the sink.
8. To enable the use of manufacturers sink clips it is necessary to add blocks of timber to the underside of the work surface where the clip is to be positioned making the total thickness 30-40mm the blocks can be secured using hot melt glue.
9. Remove any silicone squeeze out from around the outer rim of the sink.
10. Allow time for the silicone to cure before carrying out any further surface finishing.

Undermount Sinks

Jig templates should be used in the following way: position the undermount sink by taking all measurements from the sink centre as opposed to the bowl centre. Sink centres line up with the jig centres. Cut-outs can be formed using a hand router.

Face Cut-Out

Top Tip: Support your Spectra Slim-Edge work surface as you work through each process particularly at the point of creating the sink cut-out as failure to do this could lead to a temporary weakening of the work surface.

1. Position the work surface 'face up' and mark out the sink centre with a pencil.
2. Ensuring the jig handing corresponds with the desired sink handing, centralise the jig and clamp in place using four clamps, one at each corner. Place and fix the inner template with hot melt and push down to act as a support for the router to stop any potential tipping.
3. Cut into the face of the work surface with a hand router fitted with a 30mm bush guide and standard ½ inch router cutter, cutting round in 3 stages of 4mm depth increments, taking care to keep the router cut vertical during each cut.

Top Tip: Support the cut-out section with a sacrificial piece of MDF or chipboard to aid support and debris control.

4. Using a hand router, profile the inner edge using a chamfer cutter with a bottom bearing.
5. Finish the cut-out inner edge using a palm sander with 240 grit paper, followed by the nylon finishing pad from the installation kits. Sand the internal radii by hand and finish with the same nylon finishing pad.

Fitting The Sink

1. First check the sink fits by assembling a dry fit. Place the inverted sink on the underside of the cut-out to confirm it centres when viewed from the face of the work surface.

Top Tip: At this point ensure the sink lip is completely flat as this will affect the bond between stainless steel the Spectra Slim-Edge surface. Replace the sink if in any doubt.

2. Place and mark where the sink clips are to be secured. Using the drill bit supplied in installation kit 1 pilot hole to a depth of 9mm and insert the spreading dowel into the hole and tap flush. Remember to avoid obstructing any tap holes or overflows. On the underside of the Spectra Slim-edge surface using hot melt glue position blocks of MDF around the outside perimeter of the sink. This prevents the sink moving whilst the bolts are being tightened. These can be removed once the bolts are tightened.

Top Tip: It is recommended to trial fit any overflows required to assure clearance from the surrounding work surface. It may be necessary to cut clearance around the overflow.

3. Once satisfied with the final fit and clip location, remove all clips and the sink in preparation for the final installation.

Final Installation

To simplify the installation it is best to fit the sink face down making sure the sink is centered in the cut-out when viewed face up.

1. Using denatured alcohol, thoroughly clean the two joining faces of the sink lip and on the underside of the work surface around the cut area, allowing each face to evaporate dry.
2. Using clear silicone apply to the work surface. Position the sink applying gentle pressure all round ensuring the silicone squeezes out on both the back and face edges of the cut out creating a solid, waterproof bond. Centralise the sink and then tighten the sink clips using a screwdriver or allen key.
3. Turn over the work surface, centralise sink and re-tighten, then scrape off any excess silicone and clean up with denatured alcohol.
4. It is recommended to allow 24 hours before using the sink.

Top Tip: Always follow manufacturer's guidelines when fitting sinks or appliances.

Drainer Grooves (undermount sink installation only)

Top Tip: Before starting ensure you use good quality cutters and work smoothly when processing the grooves. This will reduce the final finishing time and provide an excellent finish.

Important: Always process the drainer grooves after a radius profile has been applied to the inner edge. This is so the bearing follows a flat edge and not the drainer grooves.

1. Apply masking tape to the surface to help position the grooves. Mark out the groove centre lines with a pencil ensuring they are parallel to the front edge of the work surface.
2. Centralise the required groove in the jig over the marked out centre line and firmly clamp the jig in place.
3. Use a hand router fitted with a 30mm bush guide and a radius cutter. Accurately set the plunge depth to 6mm.
Please note: Never cut deeper than 6mm.
4. Starting from the farthest point from the sink cut-out, plunge the router and run smoothly along the jig to create the groove. Smooth use of the router will minimise hand sanding when finishing.
5. Repeat the steps above to complete the remaining grooves.

Finishing Drainer Grooves

1. Carefully hand sand the drainer grooves with 180 grit if required followed by 240 grit paper then finish with the nylon finishing pad.
2. Finally apply linseed oil to the finished grooves with a cloth taking care not to over spill on to the surface of the work surface.

HOB INSTALLATION

Most work surfaces have a gap between the bottom of the hob and item immediately below it. This gap has decreased due to Spectra Slim-Edge work surfaces being only 12.5mm thick. Hobs will also vary in depth and width, therefore in order to fit, some alternations may need to be made to the running bar at the top of the unit. It can be trimmed to 25mm wide and re-fixed (white edge facing out) with one screw to each side. The off-cut of 50mm can be re-fixed to the back of the unit (if no running bar currently in place) and attached with two screws each side to give the unit additional stability.

Spectra Slim-Edge work surfaces are compatible with most hobs and fitting clips. But should an additional packer be required to secure the clips, simply utilise the material cut out for the hob.

There are no issues if a cupboard is used directly below the hob, however if intending to position an oven or drawers please refer to the following recommendations.

Oven

Recommended for single oven installation only. The shelf at the bottom of the unit can be lowered by 20mm-25mm by undoing the locating pins and replacing them further down the panels. The front panel will then need to be trimmed by the same amount from the top and a fillet added to the space between the oven and work surface. Use the fitting clips provided to secure the oven.

Drawers

Pan drawers should be used rather than standard height drawers as the additional height maintains the closing capability of the drawer

without interfering with the hob fitting. Alternatively, if standard drawers are preferred, a false top drawer (thereby a non-functioning drawer frontal) should be used.

Please note: These are recommendations only and may vary slightly depending on specifics of the cabinetry being used.

FINISHING

Spectra Slim-Edge work surfaces are supplied finished with no polishing or oiling required to the surface.

Top Tip: The use of a quality random orbital sander or palm sander should be used on all cut ends that are going to be seen, going through the recommended grits and then applying oil or laminate polish to the exposed edges. Always follow the correct grits of 180 grit > 240 grit > Nylon finishing pad 320 grit approx.

1. Ensure the sander is moved constantly over the exposed front edge keeping it flat on the edge and avoid tipping as this will cause a rounding effect to be seen during the complete sanding operation. Wipe the edge surface clean with a damp cloth between each pass to remove surface contamination.
2. Ensure you avoid just sanding up and down the edges as this could cause a groove or trenching.
3. This process will remove any saw or router marks and provide a smooth appearance to the edges. A final edge treatment with linseed oil will further enhance the edge aesthetics.

Please note: Only apply this to the edge.

Care and maintenance

CLEANING AND CARE

Spectra Slim-Edge work surfaces are easily maintained and simply require a regular wipe down with a mild detergent and water. Rinse with warm water and gently buff to dry the surface.

STAINING

Spectra Slim-Edge work surfaces have a solid, non-porous surface resistant to stains, mould, mildew and bacteria growth. We recommend normal everyday spills be wiped away without delay using a damp cloth to avoid any potential staining.

If any discolouration appears due to coffee, tea or fruit juices, the first stage is to clean the surface using a mild detergent and water. If the stain remains try an even mix of domestic bleach and warm water making sure you protect your hands with gloves.

For more stubborn stains apply a non-abrasive cream cleaner to a non-abrasive nylon brush and rub gently over the stain. Finally, if the previous methods fail, try rubbing the area in a circular motion with a Scotchbrite™ pad in warm, soapy water. At the end of each stage rinse with warm water and gently buff dry the surface.

Please Note: DO NOT use acidic or abrasive cleaners, expose the laminate to household bleach for prolonged periods of time, or apply excessive scrubbing.

SCUFFS AND SCRATCHES

Darker colours will show excessive marking, scratching and wear and tear more noticeably than lighter colours. Never cut anything directly on the work surface.

RESISTANCE TO HEAT

Please note: Never place any hot items directly from the heat source directly on to the work surface.

Slim-Edge work surfaces can become damaged if hot pans, earthenware or dishes are placed directly from the oven or hob. To prevent surface damage from hot objects it is recommended to use a heat-resistant mat or stainless steel grating on the work surface.

PRODUCT GUARANTEE

This product has been manufactured to demanding high quality standards and should last many years provided that the work surface is installed and used in accordance with the installation instructions.

Typically, manufacturing defects are visible on inspection or manifest during/soon after installation. Where a work surface can be shown to have failed by reason of manufacturing defect (subject to wear and tear), we will always consider each claim within its own merit in conjunction with your statutory rights.

Spectra Slim-Edge work surfaces are produced to a predetermined colour tolerance, however variations may occur. All work surfaces should be thoroughly checked for colour match prior to cutting or installation. Manufacturer reserves the right to determine what remedy is required – repair and/or replacement of work surfaces. Manufacturer reserves the right to request proof of date and place of purchase to support any submitted claim.

The Customer's attention is particularly drawn to the provisions of clause 12.

1. INTERPRETATION

1.1 Definitions. In these Conditions, the following definitions apply:

Blackheath: Blackheath Products Limited registered in England and Wales with company number 597879.

Business Day: a day other than a Saturday, Sunday or public holiday in England when banks in London are open for business.

Commencement Date: has the meaning set out in clause 2.2.

Conditions: these terms and conditions as amended from time to time in accordance with clause 15.7.

Contract: the contract between Blackheath and the Customer for the supply of Goods and/or Design Services in accordance with these Conditions. Customer: the person or firm who purchases the Goods and/or Design Services from Blackheath.

Deliverables: the design set out in the Order.

Delivery Location: has the meaning set out in clause 4.2.

Design Services: the design services, including the Deliverables, supplied by Blackheath to the Customer as set out in the Design Service Specification below.

Design Service Specification: the description or specification for the Design Services provided in writing by Blackheath to the Customer.

Force Majeure Event: has the meaning given to it in clause 14.1. Goods: the goods (or any part of them) set out in the Order.

Goods Specification: any specification for the Goods that is agreed in writing by the Customer and Blackheath.

Intellectual Property Rights: patents, rights to inventions, copyright and related rights, trade marks, business names and domain names, rights in get-up, goodwill and the right to sue for passing off, rights in designs, database rights, rights to use, and protect the confidentiality of, confidential information (including know-how), and all other intellectual property rights, in each case whether registered or unregistered and including all applications and rights to apply for and be granted, renewals or extensions of, and rights to claim priority from, such rights and all similar or equivalent rights or forms of protection which subsist or will subsist now or in the future in any part of the world.

Order: the Customer's order for the supply of Goods and/or Design Services, as set out in the Customer's purchase order form, or the Customer's written acceptance of Blackheath's quotation, or overleaf, as the case may be.

1.2 **"Construction".** In these Conditions, the following rules apply:

1.2.1 a **person** includes a natural person, corporate or unincorporated body (whether or not having separate legal personality);

1.2.2 a reference to a party includes its personal representatives, successors or permitted assigns;

1.2.3 a reference to a statute or statutory provision is a reference to such statute or statutory provision as amended or re-enacted. A reference to a statute or statutory provision includes any subordinate legislation made under that statute or statutory provision, as amended or re-enacted;

1.2.4 any phrase introduced by the terms **including, include, in particular** or any similar expression shall be construed as illustrative and shall not limit the sense of the words preceding those terms; and

1.2.5 a reference to writing or written includes faxes and e-mails.

2. BASIS OF CONTRACT

2.1 The Order constitutes an offer by the Customer to purchase Goods and/or Design Services in accordance with these Conditions.

2.2 The Order shall only be deemed to be accepted on the order after:

2.2.1 Blackheath issuing written acceptance of the Order;

2.2.2 any act by Blackheath consistent with fulfilling the Order, at which point and on which date the Contract shall come into existence ("**Commencement Date**").

2.3 The Contract constitutes the entire agreement between the parties. The Customer acknowledges that it has not relied on any statement, promise, representation, assurance or warranty made or given by or on behalf of Blackheath which is not set out in the Contract.

2.4 Any samples, drawings, descriptive matter or advertising issued by Blackheath and any descriptions of the Goods or illustrations or descriptions of the Design Services contained in Blackheath's catalogues or brochures are issued or published for the sole purpose of giving an approximate idea of the Design Services and/or Goods described in them. They shall not form part of the Contract or have any contractual force.

2.5 These Conditions apply to the Contract to the exclusion of any other terms that the Customer seeks to impose or incorporate, or which are implied by trade, custom, practice or course of dealing.

2.6 Any quotation given by Blackheath shall not constitute an offer, and is only valid for a period of 30 days from its date of issue.

2.7 Any typographical, clerical or other error or omission in any sales literature, quotation, acceptance of offer, invoice or other document or information issued by Blackheath shall be subject to correction without liability on the part of Blackheath.

2.8 No Order which has been accepted by Blackheath may be cancelled by the Customer except with the agreement in writing of Blackheath or the terms that the Customer shall indemnify Blackheath in full against all loss (including the cost of labour and materials used), damages, charges and expenses incurred by Blackheath as a result of cancellation.

2.9 The Customer shall comply with all applicable laws, statutes and regulations relating to anti-bribery and anti-corruption including but not limited to the Bribery Act 2010.

2.10 All of these Conditions shall apply to the supply of both Goods and Design Services except where application to one or the other is specified.

3. GOODS

3.1 The Goods are described in Blackheath's catalogue and website as modified by any applicable Goods Specification.

3.2 Blackheath reserves the right to amend the specification of the Goods if required by any applicable statutory or regulatory requirements.

4. DELIVERY OF GOODS

4.1 Blackheath shall ensure that:

4.1.1 each delivery of the Goods is accompanied by a delivery note which shows the date of the Order, all relevant Customer and Blackheath reference numbers, the type and quantity of the Goods (including the code number of the Goods, where applicable), special storage instructions (if any) and, if the Order is being delivered by instalments, the outstanding balance of Goods remaining to be delivered; and

4.1.2 if Blackheath requires the Customer to return any packaging material to Blackheath, that fact is clearly stated on the delivery note. The Customer shall make any such packaging materials available for collection at such times as Blackheath shall reasonably require. Returns of packaging materials shall be at Blackheath's expense.

4.2 Blackheath shall deliver the Goods to the location set out in the Order or such other location as the parties may agree ("**Delivery Location**") at any time after Blackheath notifies the Customer that the Goods are ready.

4.3 Delivery of the Goods shall be completed on the Goods' arrival at the Delivery Location. Blackheath shall not be responsible for unloading the Goods at the Delivery Location and, for the avoidance of doubt, shall not be required to deliver the Goods anywhere other than kerbside at the Delivery Location.

4.4 Any dates quoted for delivery of the Goods are approximate only, and the time of delivery is not of the essence. Blackheath shall not be liable for any delay in delivery of the Goods that is caused by a Force Majeure Event or the Customer's failure to provide Blackheath with adequate delivery instructions or any other instructions that are relevant to the supply of the Goods.

4.5 If Blackheath fails to deliver the Goods, its liability shall be limited to the costs and expenses incurred by the Customer in obtaining replacement goods of similar description and quality in the cheapest market available, less the price of the Goods. Blackheath shall have no liability for any failure to deliver the Goods to the extent that such failure is caused by a Force Majeure Event. The Customer's failure to provide Blackheath with adequate delivery instructions for the Goods or any relevant instruction related to the supply of the Goods.

4.6 If the Customer fails to accept or take delivery of the Goods within three Business Days of Blackheath notifying the Customer that the Goods are ready, then except where such failure or delay is caused by a Force Majeure Event or by Blackheath's failure to comply with its obligations under the Contract in respect of the Goods:

4.6.1 delivery of the Goods shall be deemed to have been completed at 9.00am on the third Business Day following the day on which Blackheath notified the Customer that the Goods were ready; and

4.6.2 Blackheath shall store the Goods until delivery takes place, and charge the Customer for all related costs and expenses (including insurance).

4.7 If four Business Days after Blackheath notified the Customer that the Goods were ready for delivery the Customer has not taken delivery of them, Blackheath may store or otherwise dispose of part or all of the Goods and, after deducting reasonable storage and selling costs, account to the Customer for any excess over the price of the Goods or charge the Customer for any shortfall below the price of the Goods. 4.8 Blackheath may deliver the Goods by instalments, which shall be invoiced and paid for separately. Each instalment shall constitute a separate contract. Any delay in delivery or defect in an instalment shall not entitle the Customer to cancel any other instalment.

5. QUALITY OF GOODS

5.1 Where Blackheath is not the manufacturer of the Goods, Blackheath shall endeavour to transfer to the Customer the benefit of any warranty or guarantee given to Blackheath.

5.2 Blackheath warrants that on delivery the Goods shall:

5.2.1 conform in all material respects with their description and any applicable Goods Specification;

5.2.2 be free from material defects in design, material and workmanship.

5.3 Subject to clause 5.5, if:

5.3.1 the Customer gives notice in writing within a reasonable time of discovery that some or all of the Goods do not comply with the warranty set out in clause 5.2;

5.3.2 Blackheath is given a reasonable opportunity of examining such Goods; and

5.3.3 the Customer (if asked to do so by Blackheath) returns such Goods and any strapping or packaging to Blackheath's place of business at the Blackheath's cost, Blackheath shall, at its option, repair or replace the defective Goods, or refund the price of the defective Goods in full. 5.4 Blackheath reserves the right to charge the Customer for the cost of inspection of the Goods and/or return of Goods where Blackheath deems the Goods to be in accordance with the warranty set out in clause 5.2.

5.5 Blackheath shall not be liable for the Goods' failure to comply with the warranty in clause 5.2 if:

5.5.1 the Customer makes any further use of such Goods after giving a notice in accordance with clause 5.4;

5.5.2 the defect arises because the Customer failed to follow Blackheath's oral or written instructions as to the storage, installation, commissioning, use or maintenance of the Goods or (if there are none) good trade practice;

5.5.3 the defect arises as a result of Blackheath following any drawing, design or Goods Specification supplied by the Customer;

5.5.4 the Customer alters or repairs such Goods without the written consent of Blackheath;

5.5.5 the defect arises as a result of fair wear and tear, willful damage, negligence, or abnormal working conditions;

5.5.6 the Goods differ from their description or the Goods Specification as a result of changes made to ensure they comply with applicable statutory or regulatory standards;

5.5.7 the Goods comply with the tolerance margins adopted by the manufacturer of the Goods. 5.6 Except as provided in this clause 5, Blackheath shall have no liability to the Customer in respect of the Goods' failure to comply with the warranty set out in clause 5.2.

5.7 The terms of these Conditions shall apply to any repaired or replacement Goods supplied by Blackheath under clause 5.3.

6. TITLE AND RISK

6.1 The risk in the Goods shall pass to the Customer on completion of delivery.

6.2 Title to the Goods shall not pass to the Customer until:

6.2.1 Blackheath receives payment in full (in cash or cleared funds) for the Goods and any other goods that Blackheath has supplied to the Customer in respect of which payment has become due, in which case title to the Goods shall pass at the time of payment of all such sums

6.3 Until title to the Goods has passed to the Customer, the Customer shall:

6.3.1 store the Goods separately from all other goods held by the Customer so that they remain readily identifiable as Blackheath's property;

6.3.2 not remove, deface or obscure any identifying mark or packaging on or relating to the Goods;

6.3.3 maintain the Goods in satisfactory condition and keep them insured against all risks for their full price on Blackheath's behalf from the date of delivery;

6.3.4 notify Blackheath immediately if it becomes subject to any of the events listed in clause 13.1.1 to clause 13.1.11; and

6.3.5 give Blackheath such information relating to the Goods as Blackheath may require from time to time.

6.4 If before title to the Goods passes to the Customer the Customer becomes subject to any of the events listed in clause 13.1.1 to clause 13.1.11, then, without limiting any other right or remedy Blackheath may have:

6.4.1 the Customer's right to resell Goods or use them in the ordinary course of its business ceases immediately; and

6.4.2 Blackheath may at any time: (a) require the Customer to deliver up all Goods in its possession which have not been resold, or irrevocably incorporated into another product; and (b) if the Customer fails to do so promptly, enter any premises of the Customer of or any third party where the Goods are stored in order to recover them.

7. SUPPLY OF DESIGN SERVICES

7.1 Blackheath shall provide the Design Services to the Customer in accordance with the Design Service Specification in all material respects.

7.2 Blackheath shall use all reasonable endeavours to meet any performance dates for the Design Services, but any such dates shall be estimates only and time shall not be of the essence for the performance of the Design Services.

7.3 Blackheath shall have the right to make any changes to the Design Services which are necessary to comply with any applicable law or safety requirement, or which do not materially affect the nature or quality of the Design Services, and Blackheath shall notify the Customer in any such event.

7.4 Blackheath warrants to the Customer that the Design Services will be provided using reasonable care and skill.

8. CUSTOMER'S OBLIGATIONS

8.1 The Customer shall:

8.1.1 ensure that the terms of the Order and (if submitted by the Customer) the Goods Specification are complete and accurate.

8.1.2 co-operate with Blackheath in all matters relating to the Design Services;

8.1.3 provide Blackheath with such information and measurements as Blackheath may reasonably require to supply the Design Services, and ensure that such information is accurate in all material respects;

8.1.4 provide Blackheath with its written acceptance of the design arising from the Design Services before any work commences on the manufacture of Goods to that design.

8.2 If Blackheath's performance of any of its obligations in respect of the Design Services is prevented or delayed by any act or omission by the Customer or failure by the Customer to perform any relevant obligation ("**Customer Default**"), 8.2.1 Blackheath shall without limiting its other rights or remedies have the right to suspend performance of the Design Services until the Customer remedies the Customer Default, and to rely on the Customer Default to relieve it from the performance of any of its obligations to the extent the Customer Default prevents or delays Blackheath's performance of any of its obligations;

8.2.2 Blackheath shall not be liable for any costs or losses sustained or incurred by the Customer arising directly or indirectly from Blackheath's failure or delay to perform any of its obligations as set out in this clause 8.2; and

8.2.3 the Customer shall reimburse Blackheath on written demand for any costs or losses sustained or incurred by Blackheath arising directly or indirectly from the Customer Default.

9. CHARGES AND PAYMENT

9.1 The price for Goods and Design Services shall be the price set out in the Order or, if no price is quoted, the price set out in Blackheath's published price list as at the date of delivery. The price of the Goods is exclusive of VAT and all costs and charges of packaging, insurance, transport of the Goods.

9.2 Blackheath reserves the right to increase the price of the Goods, by giving notice to the Customer at any time before delivery, to reflect any increase in the cost of the Goods to Blackheath that is due to:

9.2.1 any factor beyond the control of Blackheath (including foreign exchange fluctuations, increases in taxes and duties, and increases in labour, materials and other manufacturing costs);

9.2.2 any request by the Customer to change the delivery date(s), quantities or types of Goods ordered, or the Goods Specification; or

9.2.3 any delay caused by any instructions of the Customer in respect of the Goods or failure of the Customer to give Blackheath adequate or accurate information or instructions in respect of the Goods.

9.3 In respect of Goods and Design Services, Blackheath shall be entitled to invoice the Customer:

9.3.1 in the case of trade counter customers at the time of order; and

9.3.2 in the case of account Customers, at any time after completion of delivery.

9.4 Unless otherwise agreed in writing, the Customer shall pay each invoice submitted by Blackheath:

9.4.1 before the end of the month following the month in which the invoice is dated; and

9.4.2 in full and in cleared funds to a bank account nominated in writing by Blackheath, and time for payment shall be of the essence of the Contract.

9.5 For the avoidance of doubt, Blackheath shall be entitled to request payment up front at the time of order or delivery at its discretion, including without limitation where the Customer is a trade counter or account customer.

9.6 All amounts payable by the Customer under the Contract are exclusive of amounts in respect of value added tax chargeable from time to time ("**VAT**"). Where any taxable supply for VAT purposes is made under the Contract by Blackheath to the Customer, the Customer shall, on receipt of a valid VAT invoice from Blackheath, pay to Blackheath such additional amounts in respect of VAT as are chargeable on the supply of the Design Services or Goods at the same time as payment is due for the supply of the Design Services or Goods.

9.7 If the Customer fails to make any payment due to Blackheath under the Contract by the due date for payment, then the Customer shall pay interest on the overdue amount at the rate of 8% per annum above the Bank of England's base rate from time to time. Such interest shall accrue on a daily basis from the due date until actual payment of the overdue amount, whether before or after judgment. The Customer shall pay the interest together with the overdue amount.

9.8 The Customer shall pay all amounts due under the Contract in full without any set-off, counterclaim, deduction or withholding except as required by law. Blackheath may, without limiting its other rights or remedies, set off any amount owing to it by the Customer against any amount payable by Blackheath to the Customer.

10. INTELLECTUAL PROPERTY RIGHTS

All Intellectual Property Rights in or arising out of or in connection with the Design Services shall be owned by Blackheath.

11. CONFIDENTIALITY

A party ("**receiving party**") shall keep in strict confidence all technical or commercial know-how, specifications, inventions, processes or initiatives which are of a confidential nature and have been disclosed to the receiving party by the other party ("**disclosing party**"), its employees, agents or subcontractors, and any other confidential information concerning the disclosing party's business, its products and design services which the receiving party may obtain. The receiving party shall only disclose such confidential information to those of its employees, agents and subcontractors who need to know it for the purpose of discharging the receiving party's obligations under the Contract, and shall ensure that such employees, agents and subcontractors comply with the obligations set out in this clause as though they were a party to the Contract. The receiving party may also disclose such of the disclosing party's confidential information as is required to be disclosed by law, any governmental or regulatory authority or by a court of competent jurisdiction. This clause 11 shall survive termination of the Contract.

12. LIMITATION OF LIABILITY: THE CUSTOMER'S ATTENTION IS PARTICULARLY DRAWN TO THIS CLAUSE

12.1 Nothing in these Conditions shall limit or exclude Blackheath's liability for: 12.1.1 death or personal injury caused by its negligence, or the negligence of its employees, agents or subcontractors;

12.1.2 fraud or fraudulent misrepresentation.

12.2 Subject to clause 12.1:

12.2.1 Blackheath shall under no circumstances whatever be liable to the Customer, whether in contract, tort (including negligence), breach of statutory duty, or otherwise, for any loss of profit, or any indirect or consequential loss arising under or in connection with the Contract; and 12.2.2 Blackheath's total liability to the Customer in respect of all other losses arising under or in connection with the Contract, whether in contract, tort (including negligence), breach of statutory duty, or otherwise, shall in no circumstances exceed the price paid for the Goods and/or Design Services.

12.3 For the avoidance of doubt, if the Customer limits its own liability to its own customers in respect of the Goods and/or Services to a level lower than Blackheath's liability has been limited in these Conditions, Blackheath shall only be liable to the Customer to the lesser amount the Customer has limited its own liability to.

12.4 The terms implied by sections 13 to 15 of the Sale of Goods Act 1979 and the terms implied by sections 3 to 5 of the Supply of Goods and Design Services Act 1982 are, to the fullest extent permitted by law, excluded from the Contract.

12.5 This clause 12 shall survive termination of the Contract.

13. TERMINATION

13.1 Without limiting its other rights or remedies, each party may terminate the Contract with immediate effect by giving written notice to the other party if:

13.1.1 the other party suspends, or threatens to suspend, payment of its debts or is unable to pay its debts as they fall due or admits liability to pay its debts (or being a company or limited liability partnership) is deemed unable to pay its debts within the meaning of section 123 of the Insolvency Act 1986 or (being an individual) is deemed either unable to pay its debts or as having no reasonable prospect of so doing, in either case, within the meaning of section 268 of the Insolvency Act 1986 or (being a partnership) has any partner to whom any of the foregoing apply;

13.1.2 the other party commences negotiations with all or any class of its creditors with a view to rescheduling any of its debts, or makes a proposal for or enters into any compromise or arrangement with its creditors other than (where a company) for the sole purpose of a scheme for a solvent amalgamation of that other party with one or more other companies or the solvent reconstruction of that other party;

13.1.3 a petition is filed, a notice is given, a resolution is passed, or an order is made, for or in connection with the winding up of the other party (being a company) other than for the sole purpose of a scheme for a solvent amalgamation of the other party with one or more other companies or the solvent reconstruction of that other party;

13.1.4 the other party (being an individual) is the subject of a bankruptcy petition or order;

13.1.5 a creditor or encumbrancer of the other party attaches or takes possession of, or a distress, execution, sequestration or other such process is levied or enforced on or sued against, the whole or any part of its assets and such attachment or process is not discharged within 14 days;

13.1.6 an application is made to court, or an order is made, for the appointment of an administrator or if a notice of intention to appoint an administrator is given or if an administrator is appointed over the other party (being a company);

13.1.7 the holder of a qualifying charge over the assets of the other party (being a company) has become entitled to appoint or has appointed an administrative receiver;

13.1.8 a person becomes entitled to appoint a receiver over the assets of the other party or a receiver is appointed over the assets of the other party;

13.1.9 an event occurs, or proceeding is taken, with respect to the other party in any jurisdiction to which it is subject that has an effect equivalent or similar to any of the events mentioned in clause 13.1.1 to clause 13.1.8 (inclusive);

13.1.10 the other party suspends, threatens to suspend, ceases or threatens to cease to carry on, all or substantially the whole of its business;

13.1.11 the other party's financial position deteriorates to such an extent that in Blackheath's opinion the Customer's capability to adequately fulfil its obligations under the Contract has been placed in jeopardy; or

13.1.12 the other party (being an individual) dies or, by reason of illness or incapacity (whether mental or physical), is incapable of managing his own affairs or becomes a patient under any mental health legislation.

13.2 Without limiting its other rights or remedies, Blackheath may terminate the Contract with immediate effect by giving written notice to the Customer if the Customer fails to pay any amount due under this Contract on the due date for payment.

13.3 Without limiting its other rights or remedies, Blackheath may suspend the supply of Design Services or all or further deliveries of Goods under the Contract or any other contract between the Customer and Blackheath if the Customer fails to pay any amount due under this Contract on the due date for payment, the Customer becomes subject to any of the events listed in clause 13.1.1 to clause 13.1.11, or Blackheath reasonably believes that the Customer is about to become subject to any of them.

13.4 On termination of the Contract for any reason:

13.4.1 the Customer shall immediately pay to Blackheath all of Blackheath's outstanding unpaid invoices and interest and, in respect of Design Services supplied but for which no invoice has yet been submitted, Blackheath shall submit an invoice, which shall be payable by the Customer immediately on receipt;

13.4.2 the accrued rights and remedies of the parties as at termination shall not be affected, and the parties may bring any claim or demand in respect of any breach of the Contract which existed at or before the date of termination or expiry; and

13.4.3 clauses which expressly or by implication have effect after termination shall continue in full force and effect.

14. FORCE MAJEURE

14.1 For the purposes of this Contract, "**Force Majeure Event**" means an event beyond the reasonable control of Blackheath including but not limited to strikes, lock-outs or other industrial disputes (whether involving the workforce of Blackheath or any other party), failure of a utility service or transport network, act of God, war, riot, civil commotion, malicious damage, compliance with any law or governmental order, rule, regulation or direction, accident, breakdown of plant or machinery, fire, flood, storm or default of suppliers or subcontractors.

14.2 Blackheath shall not be liable to the Customer as a result of any delay or failure to perform its obligations under this Contract as a result of a Force Majeure Event.

14.3 If the Force Majeure Event prevents Blackheath from providing any of the Design Services and/or Goods for more than 4 weeks, Blackheath shall, without limiting its other rights or remedies, have the right to terminate this Contract immediately by giving written notice to the Customer.

15. GENERAL

15.1 Assignment and other dealings.

15.1.1 Blackheath may at any time assign, transfer, mortgage, charge, subcontract or deal in any other manner with all or any of its rights under the Contract and may subcontract or delegate in any manner any or all of its obligations under the Contract to a third party.

15.1.2 The Customer shall not, without the prior written consent of Blackheath, assign, transfer, charge, subcontract, declare a trust over or deal in any other manner with all or any of its rights or obligations under the Contract.

15.2 Notices.

15.2.1 Any notice or other communication given to a party under or in connection with this Contract shall be in writing, addressed to that party at its registered office (if it is a company) or its principal place of business (in any other case) or such other address as that party may have specified to the other party in writing in accordance with this clause, and shall be delivered personally or sent by prepaid first-class post or other next working day delivery service, or by commercial courier, fax or e-mail.

15.2.2 A notice or other communication shall be deemed to have been received: if delivered personally, when left at the address referred to in clause 12.2.1; if sent by pre-paid first class post or other next working day delivery service, at 9.00 am on the second Business Day after posting; if delivered by commercial courier, on the date and at the time that the courier's delivery receipt is signed; or, if sent by fax or e-mail, one Business Day after transmission.

15.2.3 The provisions of this clause shall not apply to the service of any proceedings or other documents in any legal action

15.3 Severance.

15.3.1 If any provision or part-provision of the Contract is or becomes invalid, illegal or unenforceable, it shall be deemed modified to the minimum extent necessary to make it valid, legal and enforceable. If such modification is not possible, the relevant provision or part-provision shall be deemed deleted. Any modification to or deletion of a provision or part-provision under this clause shall not affect the validity and enforceability of the rest of the Contract.

15.3.2 If any provision or part-provision of this Contract is invalid, illegal or unenforceable, the parties shall negotiate in good faith to amend such provision so that, as amended, it is legal, valid and enforceable, and, to the greatest extent possible, achieves the intended commercial result of the original provision.

15.4 **Waiver.** A waiver of any right under the Contract or law is only effective if it is in writing and shall not be deemed to be a waiver of any subsequent breach or default. No failure or delay by a party in exercising any right or remedy under the Contract or by law shall constitute a waiver of that or any other right or remedy, nor prevent or restrict its further exercise of that or any other right or remedy. No single or partial exercise of such right or remedy shall prevent or restrict the further exercise of that or any other right or remedy.

15.5 **No partnership or agency.** Nothing in the Contract is intended to, or shall be deemed to, establish any partnership or joint venture between any of the parties, nor constitute either party the agent of another party for any purpose. Neither party shall have authority to act as agent for, or to bind, the other party in any way.

15.6 **Third parties.** A person who is not a party to the Contract shall not have any rights to enforce its terms.

15.7 **Variation.** Except as set out in these Conditions, no variation of the Contract, including the introduction of any additional terms and conditions shall be effective unless it is agreed in writing and signed by Blackheath. For the avoidance of doubt, any variation to a term of the Contract shall not affect the remaining terms of these Conditions.

15.8 **Governing law.** This agreement and any dispute or claim arising out of or in connection with it or its subject matter or formation (including non-contractual disputes or claims) shall be governed by and construed in accordance with the law of England and Wales.

15.9 **Jurisdiction.** Each party irrevocably agrees that the courts



For sales and technical information please call 0121 561 4245,
or contact your Spectra Slim-Edge retailer.

spectra  **Slim-Edge**
collection Contemporary laminate surfaces

spectraworksurfaces.co.uk

Whilst every effort has been made to accurately represent the Spectra décors and textures, we're unable to guarantee an exact match due to the limitations of the brochure printing process. E&OE. We reserve the right to amend specifications of products without notice. All dimensions are nominal.